

Montageanleitung für Stahldübel V4A und VZ

EN - Mounting Instructions for Steel plug V4A and VZ
 FR - Mode d'emploi Cheville mecanique acier V4A et VZ
 NL - Montagevoorschrift Inslaganker V4A en VZ
 DK - Montagevejledning Slaganker V4A og VZ
 NO - Montasje Anvisning Innslagsbolt V4A og VZ
 FI - Asennusohje Lyöntiankkuri V4A ja VZ
 IT - Manuale di montaggio Tasselo a percussione V4A e VZ
 ES - Instrucciones de montaje Taco hembra V4A y VZ

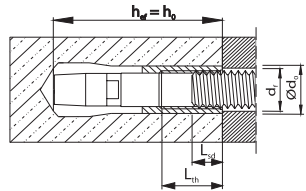

Original \diamond E

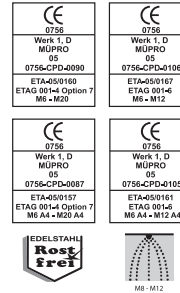

!!

Original \diamond ME



!!

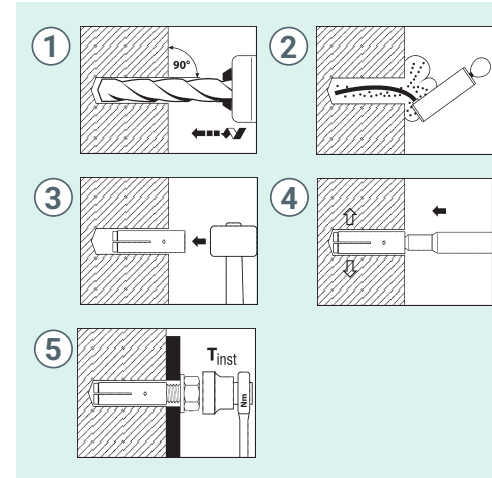

E	M	$\emptyset d_0$	d_f	h_0	h_{ef}	L_{th}	L_{sd}	T_{inst}
E A4	[mm]	[mm]	[mm]	[mm]	[mm]	[mm]	[mm]	[Nm]
EM 6	M6	8	7	30	30	13	7	4
EM 8	M8	10	9	30	30	13	9	8
EM 8x40	M8	10	9	40	40	20	9	8
EM 10	M10	12	12	40	40	15	12	15
EM 12	M12	15	14	50	50	18	14	35
EM 16	M16	20	18	65	65	23	18	60
EM 20	M20	25	22	80	80	34	22	120

MÜPRO GmbH
 Borsigstraße 14
 65205 Wiesbaden
 Deutschland
 Tel.: +49 (61 22) 80 80
 Fax: +49 (61 22) 47 02
 www.muepro.de